



MAKES THINGS EASY

TOP FEATURES

DXF Batch Processing (ATP) for Nested-Based Sheets

Small Part Handling

Accurate 2D Machining & Toolpathing

Toolpath Editing

Powerful CAD Drawing Tools

Dimensions

Vectorization (Raster to Vector Conversion) to Clean Up Artwork

Automatic Cleanup

V-Bit Carving & Engraving

Output Simulation

True-Shape & Quick-Fit Nesting

Hatch, Island & Spiral Fill Toolpathing

Output to Multiple Machines (Posts Included)

Rapid Textures

Parametric Texturing (17 Vector-Based Textures with Full Parameters & Preview)

3D Surfacing (Round, Bevel, Flat, Chamfer, Apply Mesh or Bitmap)

Relief Editing (Add, Subtract, Merge or Replace—Smooth, Bevel, Dome, Flat or Blend)

EnRoute WOOD

EnRoute WOOD PRO

EnRouteSoftware.com



YOUR DESIGN...

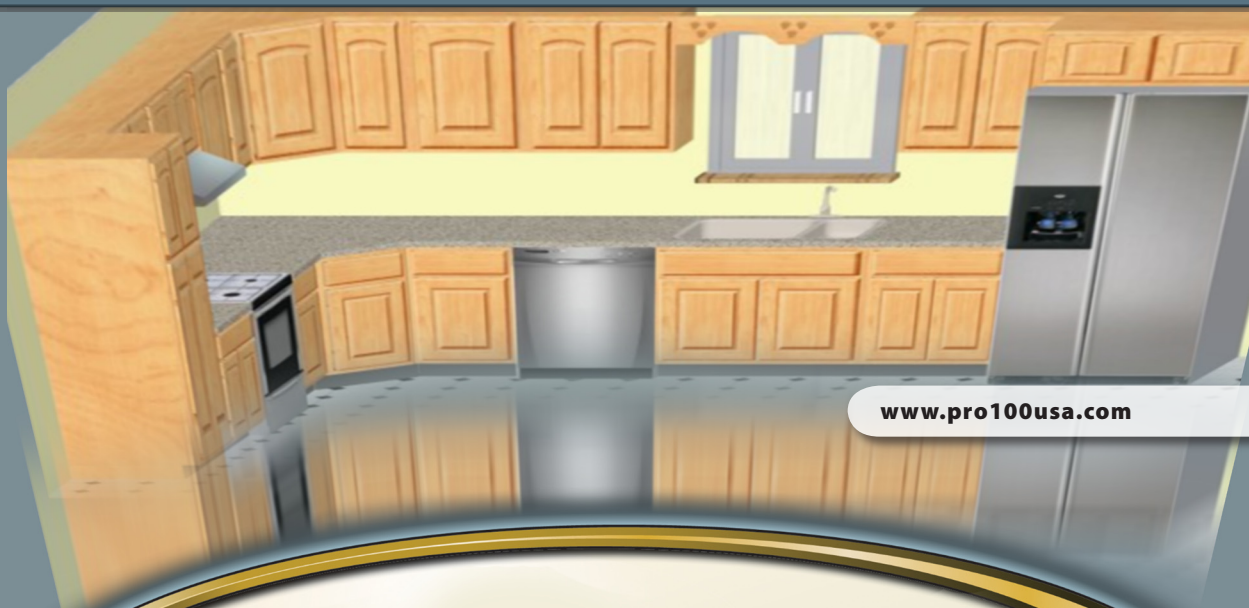

www.pro100usa.com

EnRoute

SOFTWARE

N300 G0 Z23.05
N310 X1228.345
N320 G1 Z9.525 F254
N330 G3 X1226.661 Y779.78 I-1.684 J-1.684 F508
N340 G1 X617.061
N350 G3 X614.68 Y777.399 IO. J-2.381
N360 G1 Y2.699
N370 G3 X617.061 Y0.318 I2.381 JO.
N380 G1 X1226.661
N390 G3 X1229.043 Y2.699 IO. J2.381
N400 G1 Y777.399
N410 G3 X1228.345 Y779.083 I-2.381 JO.
N420 G0 Z23.05
N430
N440 G1 Z0. F254
N450 G3 X1226.661 Y779.78 I-1.684 J-1.684 F508
N460 G1 X617.061
N470 G3 X614.68 Y777.399 IO. J-2.381
N480 G1 Y2.699
N490 G3 X617.061 Y0.318 I2.381 JO.
N100 G1 X2.381
N110 G3 X0. Y777.399 IO. J-2.381
N120 G1 Y2.699
N130 G3 X2.381 Y0.318 I2.381 JO.
N140 G1 X611.981
N150 G3 X614.363 Y2.699 IO. J2.381
N160 G1 Y777.399
N170 G3 X613.665 Y779.083 I-2.381 JO.
N180 G0 Z23.05
N190
N200 G1 Z0. F254
N210 G3 X611.981 Y779.78 I-1.684 J-1.684 F508
N220 G1 X2.381
N230 G3 X0. Y777.399 IO. J-2.381
N240 G1 Y2.699
N250 G3 X2.381 Y0.318 I2.381 JO.
N260 G1 X611.981
N270 G3 X614.363 Y2.699 IO. J2.381
N280 G1 Y777.399
N290 G3 X613.665 Y779.083 I-2.381 JO.
N300 G0 Z23.05
N310 X1228.345
N320 G1 Z9.525 F254
N330 G3 X1226.661 Y779.78 I-1.684 J-1.684 F508
N340 G1 X617.061
N350 G3 X614.68 Y777.399 IO. J-2.381
N360 G1 Y2.699
N370 G3 X617.061 Y0.318 I2.381 JO.
N380 G1 X1226.661
N390 G3 X1229.043 Y2.699 IO. J2.381
N400 G1 Y777.399
N410 G3 X1228.345 Y779.083 I-2.381 JO.
N420 G0 Z23.05
N430
N440 G1 Z0. F254
N450 G3 X1226.661 Y779.78 I-1.684 J-1.684 F508
N460 G1 X617.061
N470 G3 X614.68 Y777.399 IO. J-2.381
N480 G1 Y2.699
N490 G3 X617.061 Y0.318 I2.381 JO.

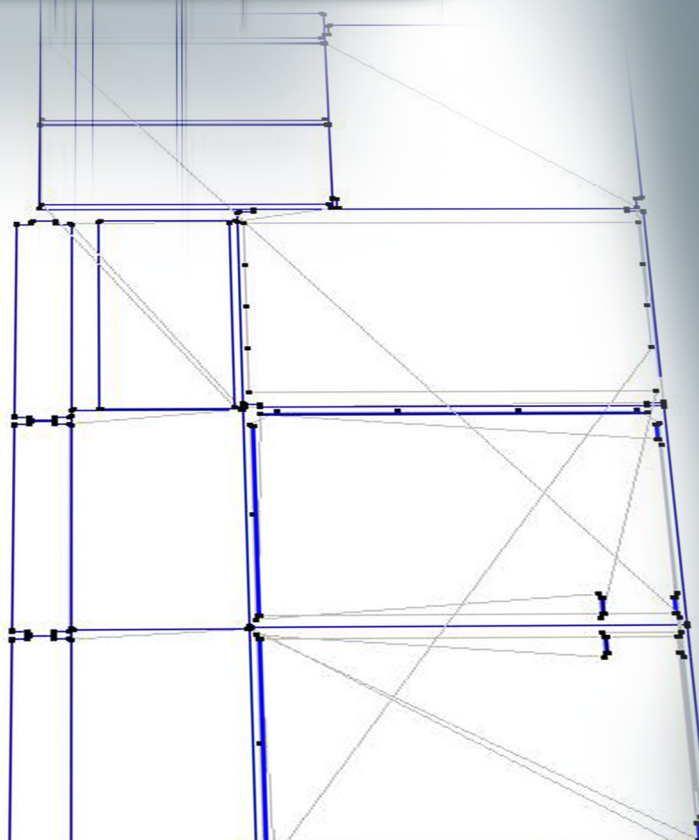

... TO NESTED SHEETS